

White Over Cover Assembly

1. Accessories

- 1 x White Over cover
- 1 x Tube punch
- 3 x sets of straps and plastic eyelets

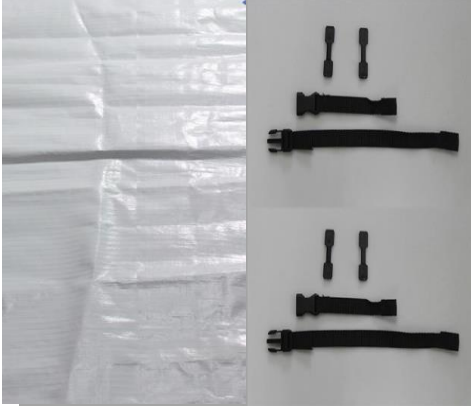

2. Assembly

- 2.1 Measure and cut the over cover to the required length
- 2.2 Use punch tube to make holes in the centre and on each ends on



3. Attach the straps to the eyelets

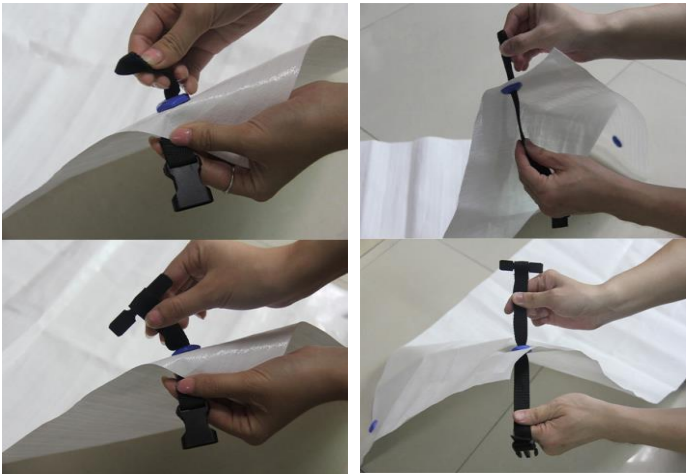

4. Place the cover over the rolled up pool cover and connect straps clips

